

INTERSTOP®



RHI MAGNESITA

STEEL / FLOW CONTROL TECHNOLOGY

Ladle Gate Type CS

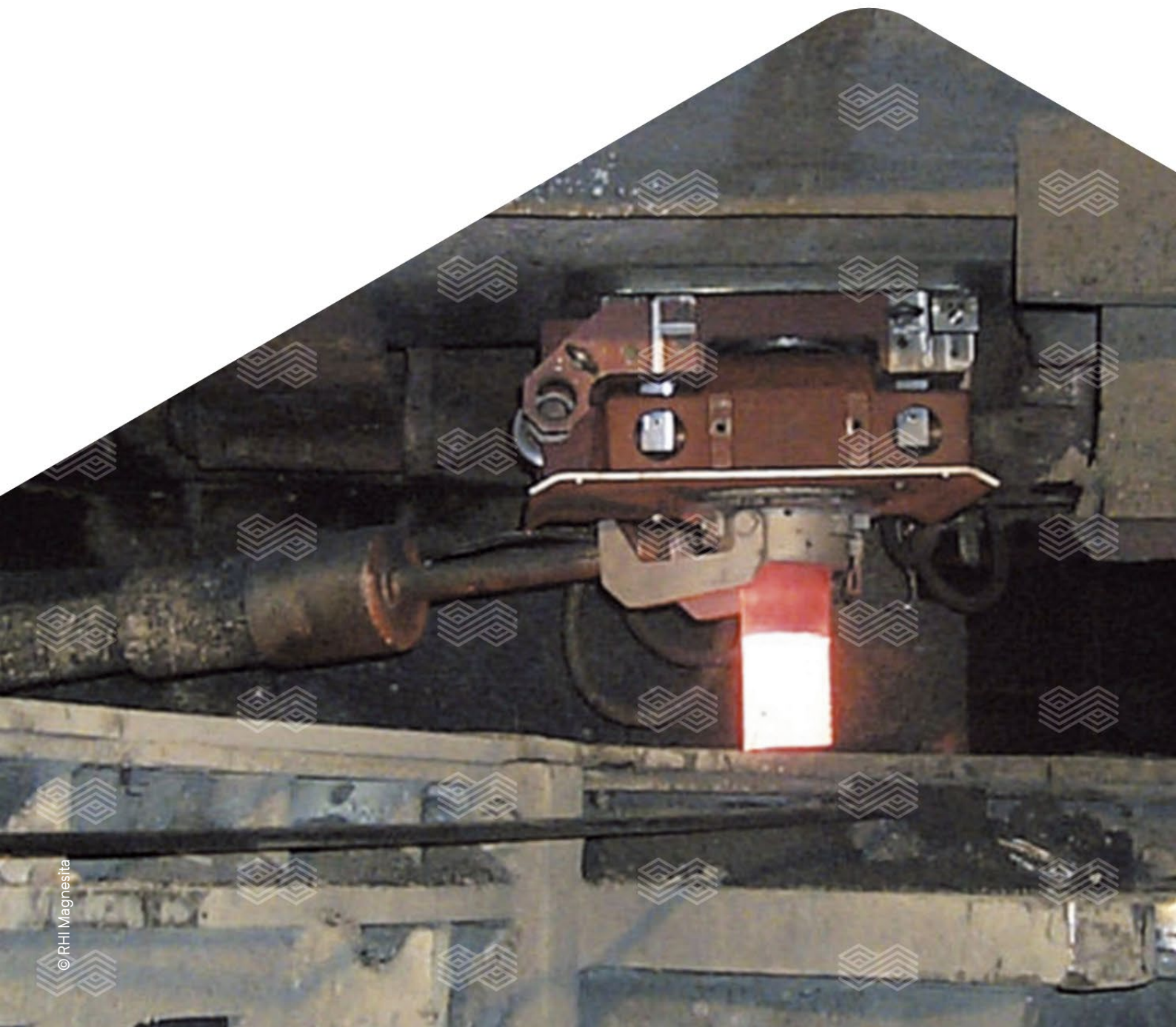

Ladle Gate Type CS

Overview

- Smaller and compact ladle gate system
- Advanced refractory design
- Safe settings of plates — no clamping necessary

- Longer working stroke
- Minimized maintenance
- Low operational costs

A: maximum casting diameter B: working stroke B+M: assembly stroke

Type	Dimensions											
	A	B	C	D	E	F	G	H	I	K	L	M
	mm	mm	mm	mm	mm	mm	mm	mm	mm	mm	mm	mm
CS 60	60	160	348	428	359	335	283	230	414	295	415	80
CS 80	80	200	388	508	396	376	291	260	427	307	440	85
CS 100	100	240	428	583	456	416	295	280	437	317	455	85

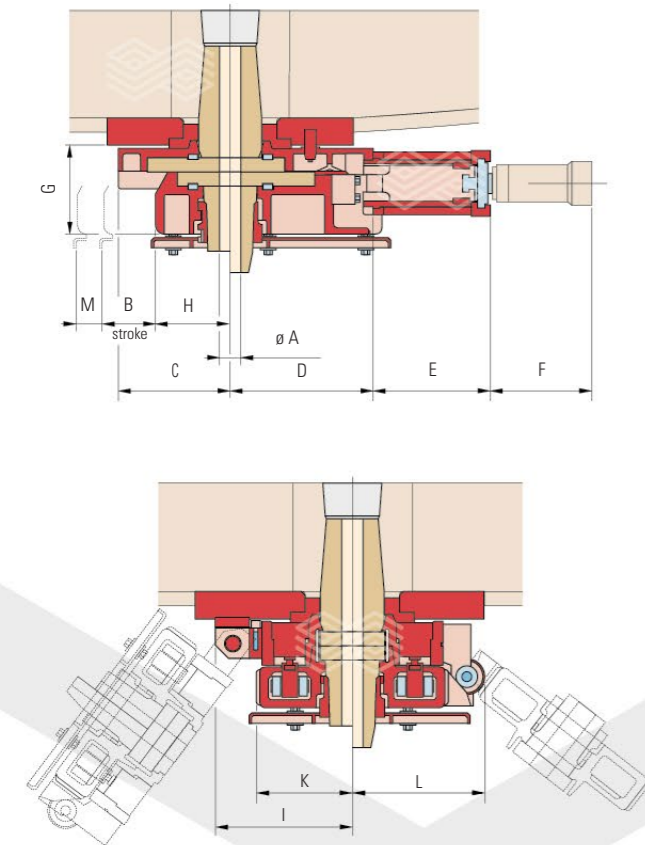

Main parts

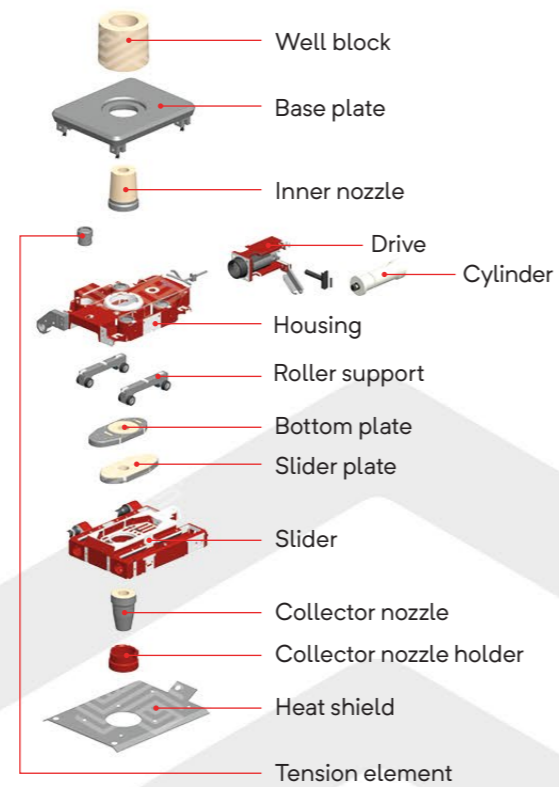

Concept

- Two main components only:
 - > Housing and slider
- Double hinged ladle gate:
 - > swiveling of slider:
 - easy assembling of the plates
 - > swiveling of ladle gate unit:
 - easy access to tension elements
 - easy access to early slag detection system
 - easy setting of a jumbo nozzle
 - exchange of jumbo nozzle without replacing plates and exchangeable nozzle

- Automatic tensioning system through additional assembly stroke
- No extra device for releasing the system tension
- Designed for automatic casting
- High temperature resistant tension elements
- High safety standard for operator and CCM

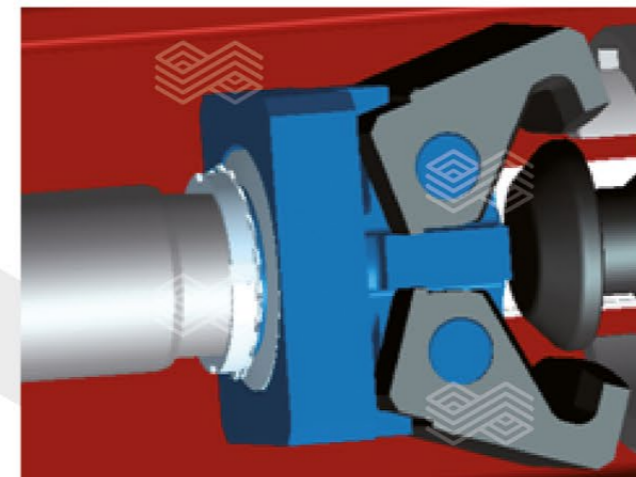
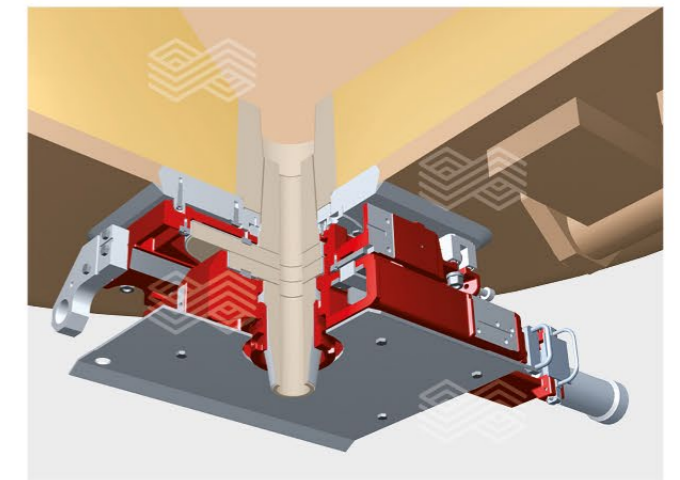
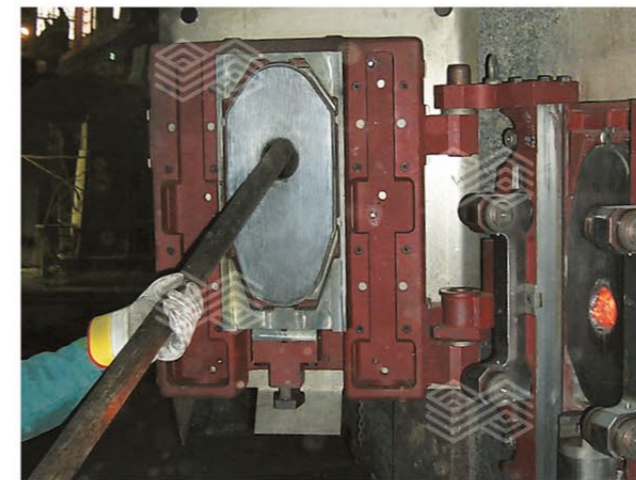

SNAP automatic cylinder coupling

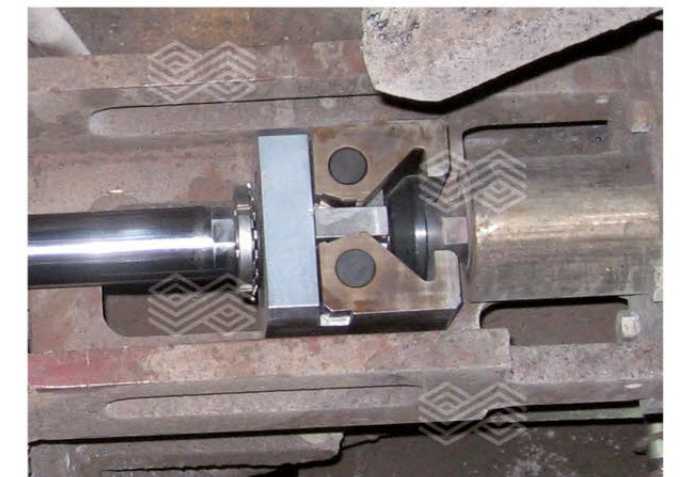

Imprint:

Media owner and publisher: RHI Magnesita GmbH, Kranichberggasse 6, 1120 Vienna, Austria
Produced by: RHI Magnesita — 12 / 2018-10-EN
Place of publication and production: Vienna, Austria

Copyright notice:

The texts, photographs and graphic design contained in this publication are protected by copyright. Unless indicated otherwise, the related rights of use, especially the rights of reproduction, dissemination, provision and editing, are held exclusively by RHI Magnesita. Usage of this publication shall only be permitted for personal information purposes. Any type of use going beyond that, especially reproduction, editing, other usage or commercial use is subject to explicit prior written approval by RHI Magnesita.

Stopinc Aktiengesellschaft

Bösch 83a, 6331 Hünenberg, Switzerland
T +41 41 785 75 00 F +41 41 785 75 01
E interstop@rhimaginesita.com

INTERSTOP (Shanghai) Co. Ltd.

Rm. 1803 Lippo Plaza, No. 222 Huaihai (M) Rd., 200021 Shanghai, P. R. China
T +86 21 23199507
E interstop@rhimaginesita.com

RHI US LTD, INTERSTOP Slide Gate Technology

3956 Virginia Avenue, Cincinnati, Ohio 45227 USA
T +1 513 527 6160 F +1 513 272 5489
E interstop@rhimaginesita.com

RHI MAGNESITA

Kranichberggasse 6, 1120 Vienna, Austria
T +43 50213 0 F +43 50213 6213
E steel@rhimaginesita.com



RHI MAGNESITA

rhimaginesita.com

