

INTERSTOP®



RHI MAGNESITA

STEEL / FLOW CONTROL TECHNOLOGY

Tundish Gate Submerged Nozzle Changer Type 33QC-SNC/A



Tundish Gate Submerged Nozzle Changer Type 33QC-SNC/A

Overview

- Increased sequence length on tundish set-up due to SN change
- Low operational costs
- Play-free drive coupling
- No interruption of casting operation during SN change
- Increased productivity of the caster
- Process control technology for automatic casting
- Off-line assembly

Concept

- Combination of the proven INTERSTOP® Tundish Gate 33QC and the INTERSTOP® Submerged Nozzle Changer SNC-N
- No interruption of casting operation during SN change (1 sec)
- Two independent and heat-shielded tensioning systems
- Inert gas application on tundish nozzle and plate joints
- Air-tight system concept supported by argon bath principle
- Fully supported lower plate for best plate stability and system tightness
- Blank plate for emergency shut-off

INTERSTOP® Flow Control Technology

- Automatic monitoring by detailed process visualization
- Fully automatic start-up features
- Automatic mold level control
- Precise steel flow regulation independent of refractory wear
- Programs for early breakout detection and mold overflow
- Long sequence casting

Assembly

- Ready-to-use refractories
- Tundish nozzle setting from inside or outside possible
- Separate preheating of submerged nozzle possible
- Semi-robotic SN handling available
- Tight push edge refractory design
- Eccentric self-locking design of housing
- Compact design
- Easy assembly and maintenance, designed to minimize the number of components

Mounting and Drive

- Configurable gates, no specific left or right gate required
- High availability of 33QC-SNC/A units due to off-line handling
- Easy and quick mounting of the 33QC-SNC/A to the tundish bottom
- by means of an assembly car
- Easily detachable hydraulic cylinders
- Hydraulic cylinders remain on tundish car
- All hydraulic circuits are closed-loop
- Designed for fully automatic casting
- High safety standard for operator and CCM

Main parts

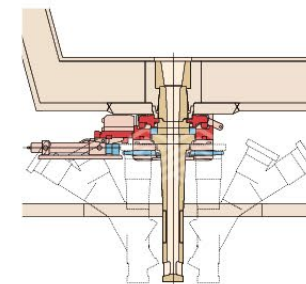
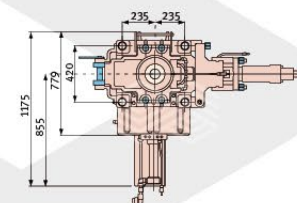
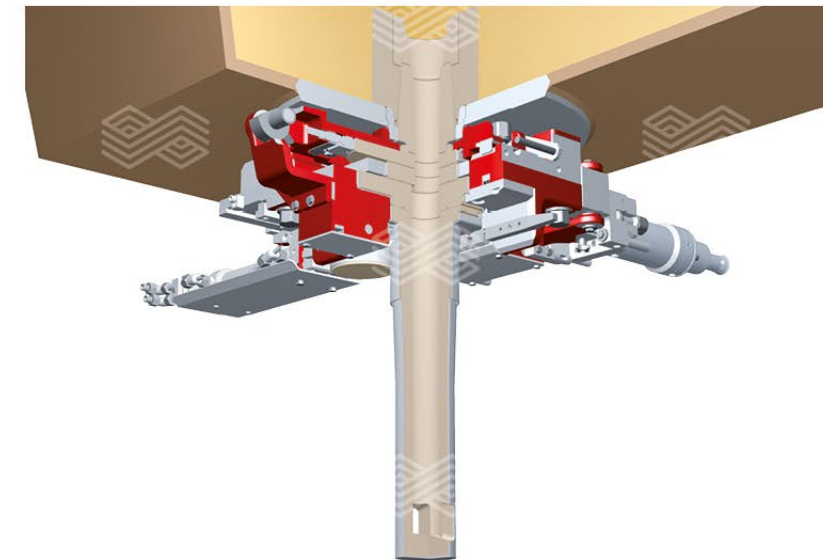
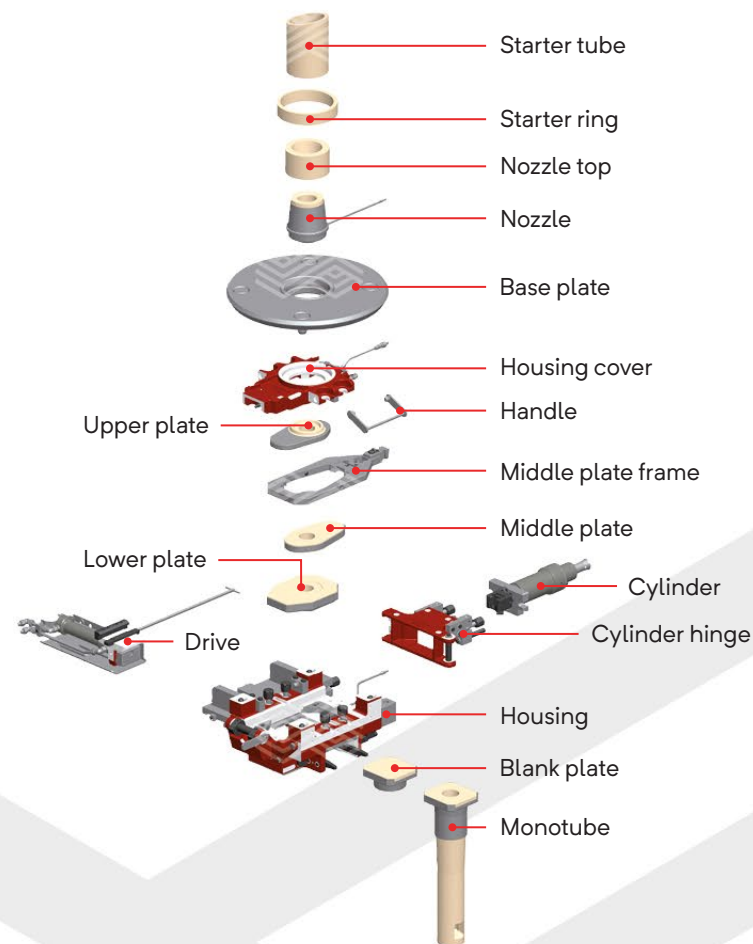

Dimensions in mm

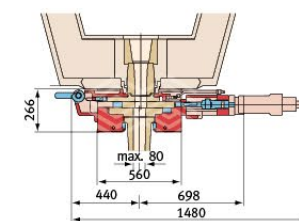

Tight push edges

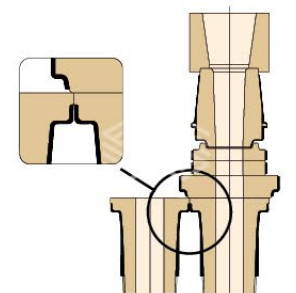

Imprint:

Media owner and publisher: RHI Magnesita GmbH, Kranichberggasse 6, 1120 Vienna, Austria

Produced by: RHI Magnesita — 12 / 2018-10-EN

Place of publication and production: Vienna, Austria

Copyright notice:

The texts, photographs and graphic design contained in this publication are protected by copyright. Unless indicated otherwise, the related rights of use, especially the rights of reproduction, dissemination, provision and editing, are held exclusively by RHI Magnesita. Usage of this publication shall only be permitted for personal information purposes. Any type of use going beyond that, especially reproduction, editing, other usage or commercial use is subject to explicit prior written approval by RHI Magnesita.

Stopinc Aktiengesellschaft

Bösch 83a, 6331 Hünenberg, Switzerland

T +41 41 785 75 00 F +41 41 785 75 01

E interstop@rhimaginesita.com

INTERSTOP (Shanghai) Co. Ltd.

Rm. 1803 Lippo Plaza, No. 222 Huaihai (M) Rd., 200021 Shanghai, P. R. China

T +86 21 23199507

E interstop@rhimaginesita.com

RHI US LTD, INTERSTOP Slide Gate Technology

3956 Virginia Avenue, Cincinnati, Ohio 45227 USA

T +1 513 527 6160 F +1 513 272 5489

E interstop@rhimaginesita.com

RHI MAGNESITA

Kranichberggasse 6, 1120 Vienna, Austria

T +43 50213 0 F +43 50213 6213

E steel@rhimaginesita.com



RHI MAGNESITA

rhimaginesita.com

